



# VALKYRIE AS



## ADDRESSABLE WALL SOUNDER/BEACON

MADE IN PORTUGAL - EU

### GLOBAL FIRE EQUIPMENT S.A.

Parque Industrial Municipal da Barracha, 8150-017 São Brás de Alportel - PORTUGAL | Tel: +351 289 896 560  
 Email: info@globalfire-equipment.com | Technical Support: techs@globalfire-equipment.com | www.globalfire-equipment.com

### TECHNICAL SPECIFICATIONS

SUPPLY VOLTAGE	Loop Powered - 20V to 30V DC
LOOP CURRENT - QUIESCENT	550 uA max. with isolator
LOOP CURRENT - SOUNDER/BEACON ACTIVE	10mA - 280mW @ 28V DC included isolator
MAXIMUM SOUNDER OUTPUT	100 dB (@ 1 meter - 30V DC)
LIGHT FLASH RATE	0,92 Hz
RESET/START-UP TIMES	20 seconds max.
SENSITIVITY / PROTECTION	According to EN54-3 / Type A - Indoor Use - Rating IP21C
CABLE SIZE / MAX. HUMIDITY	0.5-2.5 mm <sup>2</sup> / 95% RH Non-Condensing
COLOUR / CASE MATERIAL	Red or White / ABS and PC
OPERATION TEMPERATURE	-10°C to 55°C
DIMENSIONS	110 (D) x 85 (H) mm inc. base
WEIGHT	254g inc. base & 304g inc. packaging

For EN54-13 compliance, please check the control panel manual specifications.

ORDER CODE	DESCRIPTION	CERTIFICATE
VALKYRIE AS-WHITE	ADDRESSABLE WALL SOUNDER-WHITE	1328-CPR-0286 / 0359-UKCA-CPR-00193
VALKYRIE AS-RED	ADD. WALL SOUNDER-RED	1328-CPR-0286 / 0359-UKCA-CPR-00193
VALKYRIE ASI-WHITE	ADD. WALL SOUNDER-WHITE WITH LOOP ISOLATOR	1328-CPR-0286 / 0359-UKCA-CPR-00193
VALKYRIE ASI-RED	ADD. WALL SOUNDER-RED WITH LOOP ISOLATOR	1328-CPR-0286 / 0359-UKCA-CPR-00193
VALKYRIE ASB-WHITE	ADD. WALL SOUNDER/BEACON-WHITE	1328-CPR-0286 / 0359-UKCA-CPR-00193
VALKYRIE ASB-RED	ADD. WALL SOUNDER/BEACON-RED	1328-CPR-0286 / 0359-UKCA-CPR-00193
VALKYRIE ASBI-WHITE	ADD. WALL SOUNDER/BEACON-WHITE WITH ISOLATOR	1328-CPR-0286 / 0359-UKCA-CPR-00193
VALKYRIE ASBI-RED	ADD. WALL SOUNDER/BEACON-RED WITH ISOLATOR	1328-CPR-0286 / 0359-UKCA-CPR-00193

### SOUNDER BASE - LOOP CONNECTIONS

**Please note that this device is polarised.**

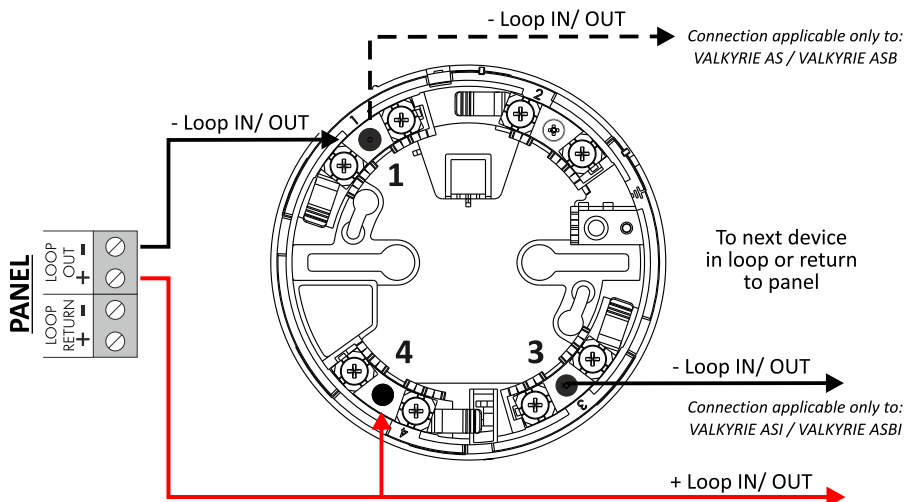

**NOTE:** Address programmed on switches 1-5 has an OFFSET of 94. For example if D.I.L. switches 1-5 are all set to OFF the actual sounder address, as read by the panel, will be 94.

## MECHANICAL SPECIFICATIONS

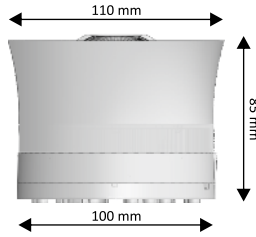

### BASE LOCK



To lock sounder remove pin available at terminal 4 on the underside of the sounder using a small screwdriver.

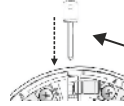

To unlock sounder from its base push provided unlock key through hole available on the base side wall as shown.

### D.I.L. SWITCHES CONFIGURATION

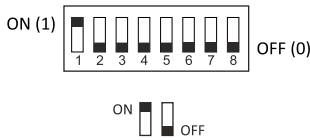

**Switches 1-5**  
Used to configure address in the range 94-125

**Switch 6 and 7**  
Tone Selection

**Switch 8**  
Shadow Sounder

**Address Switches**

- 1 ON = 1
- 2 ON = 2
- 3 ON = 4
- 4 ON = 8
- 5 ON = 16

**Sounder Type**

- Switch No. 8
- OFF = Shadow
- ON = Normal

### TONE SELECTION

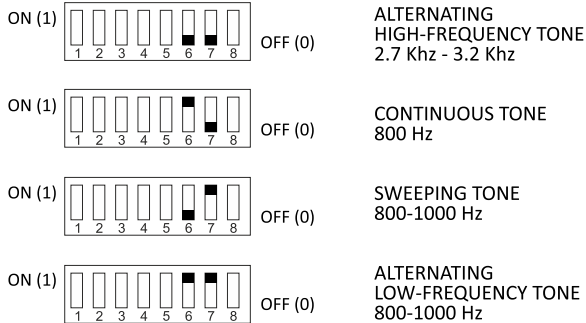

### SOUNDER/BEACON ADDRESS SETTINGS

Sounder 1	Sounder 2	Sounder 3	Sounder 4	Sounder 5	Sounder 6	Sounder 7	Sounder 8
94	95	96	97	98	99	100	101
Sounder 9	Sounder 10	Sounder 11	Sounder 12	Sounder 13	Sounder 14	Sounder 15	Sounder 16
102	103	104	105	106	107	108	109
Sounder 17	Sounder 18	Sounder 19	Sounder 20	Sounder 21	Sounder 22	Sounder 23	Sounder 24
110	111	112	113	114	115	116	117
Sounder 25	Sounder 26	Sounder 27	Sounder 28	Sounder 29	Sounder 30	Sounder 31	Sounder 32
118	119	120	121	122	123	124	125