

## Introduction

The SS-20 Indoor Siren will go off on-site, with a loud 104dB siren sound, to deter any would-be intruders when a sensor of K1/K2 system has been triggered. It is smart to have 2-4 sirens strategically placed around your home as it easily deters any intruder if they defeated one siren but still hear NOISE! Intruders DO NOT like attention.

## Pairing to the K1/K2 Hub

This Siren needs to be paired to the K1/K2 Hub first before use. To pair the Siren, please refer to the K1/K2 Hub's user manual or in the K1/K2 section of the smanos home app, press the "+" button and follow the instructions on the Accessories page to easily add your smanos SS-20 siren.

## Product Overview

### Back View with mounting plate & level



Tamper Switch LED Indicator

### LED Indicator

**Blinks rapidly:** K1/K2 system is alarming.

**Blinks once per 3 seconds:** Low battery, please change the batteries.

### Tamper Switch

Anti-tamper protection ensures that any attempts to move the Siren off the Mounting Plate will result in an alarm, push notification and possible email if selected.

## Installation

The Siren can be placed in any location as long as it is within the range with K1/K2 Hub



Set the K1/K2 system to Test Mode, and then trigger the Siren by pressing the Tampering Switch on the back of the Siren. K1/K2 Hub will sound 3 beeps to confirm that the sensor is placed within range of the hub prior to installation.



Install the Siren using either the double-sided tape or the screws with mollys included in the package.

**Notice:** Removing the Back Cover off the Siren will result in an alarm. You can disarm the alarm through your K1/K2 app and then continue the installation.

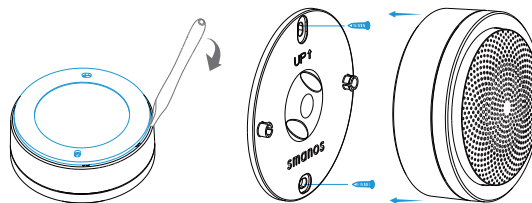

## Specifications

**Model:** SS-20

**Power:** 3V CR123A Li-Mn battery x 4 pcs

**Sound:** 104 Decibels

**Frequency:**

UPC 859756005223 915MHz

EAN 8718868403964 868MHz

**ERP (dBm) Max.:** -5.81

**Wireless range:** ≤ 80 m (in open area)

**Operating conditions:**

0-50°C/32° - 122°F, humidity < 90% RH (non-condensing)

**Dimensions (L x W x H):** 85 x 85 x 37mm/3.35" x 3.35" x 1.46"



#### EN INFORMATION FOR THE USERS

At the end of its life, the device has to be separated from the other waste. Consign the device and all its components together to a center of electrical and electrotechnical waste recycling center, designated by your local authorities.

#### DE INFORMATIONEN FÜR DIE BENUTZER

Das Gerät am Ende seiner Lebensdauer von den anderen Abfällen getrennt werden muss. Der Benutzer sollte das Gerät und alle seine Komponenten zusammen mit einem geeigneten Zentrum des elektronischen und elektrotechnischen Abfallrecyclingzentrum, das von ihren örtlichen Behörden benannt ist, verteilen.

#### FR INFORMATIONS POUR LES UTILISATEURS

Qu'en fin de vie, l'appareil doit être séparé des autres déchets. Consigner l'appareil et tous ses composants dans un centre approprié de recyclage des déchets électroniques et électrotechniques, désigné par vos autorités locales.

#### NL INFORMATIE VOOR DE GEBRUIKERS

Aan het einde van zijn levensduur moet het apparaat van het andere afval worden gescheiden. Verzend het apparaat en alle componenten samen naar een centrum voor elektronische en elektrotechnische afvalrecycling, aangewezen door uw lokale autoriteiten.

#### ES INFORMACION DEL USUARIO

Al final de su vida útil, el dispositivo debe separarse de los otros residuos. El usuario debe remitir el dispositivo y todos sus componentes a un centro adecuado de centro de reciclaje electrotécnico, designado por las autoridades locales.

#### PT A INFORMACAO DOS UTILIZADORES

No final de sua vida, o dispositivo deve ser separado dos outros resíduos. O usuário deve consignar o dispositivo e todos os seus componentes em um centro apropriado de reciclagem de resíduos eletrônicos e eletrotécnicos, designado pelas autoridades locais.

#### IT INFORMAZIONE AGLI UTENTI

Il simbolo del cassonetto barrato riportato sull'apparecchiatura indica che il prodotto alla fine della propria vita utile deve essere raccolto separatamente dagli altri rifiuti. L'utente dovrà, pertanto, conferire l'apparecchiatura integra dei componenti essenziali giunta a fine vita agli idonei centri di raccolta differenziata dei rifiuti elettrici ed elettronici, oppure riconsegnarla al rivenditore al momento dell'acquisto di nuova apparecchiatura di tipo equivalente. Lo smaltimento abusivo del prodotto da parte dell'utente comporta l'applicazione delle sanzioni amministrative di cui al Decreto Legislativo N. 49 del 14 Marzo 2014.

#### PL INFORMACJE DLA UŻYTKOWNIKÓW

Pod koniec okresu eksploatacji urządzenie należy oddzielić od pozostałych odpadów. Umieść urządzenie wraz ze wszystkimi jego częściami w centrum przetwarzania odpadów elektronicznych i elektrotechnicznych, wyznaczonego przez lokalne władze.

## FCC STATEMENT

1.This device complies with Part 15 of the FCC Rules. Operation is subject to the following two conditions:

- (1)This device may not cause harmful interference.
  - (2)This device must accept any interference received, including interference that may cause undesired operation.
2. Changes or modifications not expressly approved by the party responsible for compliance could void the user's authority to operate the equipment.

NOTE: This equipment has been tested and found to comply with the limits for a Class B digital device, pursuant to Part 15 of the FCC Rules. These limits are designed to provide reasonable protection against harmful interference in a residential installation.

This equipment generates uses and can radiate radio frequency energy and, if not installed and used in accordance with the instructions, may cause harmful interference to radio communications. However, there is no guarantee that interference will not occur in a particular installation. If this equipment does cause harmful interference to radio or television reception, which can be determined by turning the equipment off and on, the user is encouraged to try to correct the interference by one or more of the following measures:

Reorient or relocate the receiving antenna.

Increase the separation between the equipment and receiver.

Connect the equipment into an outlet on a circuit different from that to which the receiver is connected.

Consult the dealer or an experienced radio/TV technician for help.

#### FCC Radiation Exposure Statement:

This equipment complies with FCC radiation exposure limits set forth for an uncontrolled environment. In order to avoid the possibility of exceeding the FCC radio frequency exposure limits, Human proximity to the antenna shall not be less than 20cm(8 inches) during normal operation.

## Industry Canada Notice

This device complies with Industry Canada licence-exempt RSS standard(s).

1. Operation is subject to the following two conditions:
- (1) this device may not cause interference, and (2) this device must accept any interference, including interference that may cause undesired operation of the device.
2. Changes or modifications not expressly approved by the party responsible for compliance could void the user's authority to operate the equipment.



#### EN INFORMATION FOR THE USERS

At the end of its life, the device has to be separated from the other waste. Consign the device and all its components together to a center of electrical and electrotechnical waste recycling center, designated by your local authorities.

#### DE INFORMATIONEN FÜR DIE BENUTZER

Das Gerät am Ende seiner Lebensdauer von den anderen Abfällen getrennt werden muss. Der Benutzer sollte das Gerät und alle seine Komponenten zusammen mit einem geeigneten Zentrum des elektronischen und elektrotechnischen Abfallrecyclingzentrum, das von ihren örtlichen Behörden benannt ist, verteilen.

#### FR INFORMATIONS POUR LES UTILIZATEURS

Qu'en fin de vie, l'appareil doit être séparé des autres déchets. Consigner l'appareil et tous ses composants dans un centre approprié de recyclage des déchets électroniques et électrotechniques, désigné par vos autorités locales.

#### NL INFORMATIE VOOR DE GEBRUIKERS

Aan het einde van zijn levensduur moet het apparaat van het andere afval worden gescheiden. Verzend het apparaat en alle componenten samen naar een centrum voor elektronische en elektrotechnische afvalrecycling, aangewezen door uw lokale autoriteiten.

#### ES INFORMACION DEL USUARIO

Al final de su vida útil, el dispositivo debe separarse de los otros residuos. El usuario debe remitir el dispositivo y todos sus componentes a un centro adecuado de centro de reciclaje electrotécnico, designado por las autoridades locales.

#### PT A INFORMACAO DOS UTILIZADORES

No final de sua vida, o dispositivo deve ser separado dos outros resíduos. O usuário deve consignar o dispositivo e todos os seus componentes em um centro apropriado de reciclagem de resíduos eletrônicos e eletrotécnicos, designado pelas autoridades locais.

#### IT INFORMAZIONE AGLI UTENTI

Il simbolo del cassonetto barrato riportato sull'apparecchiatura indica che il prodotto alla fine della propria vita utile deve essere raccolto separatamente dagli altri rifiuti. L'utente dovrà, pertanto, conferire l'apparecchiatura integra dei componenti essenziali giunta a fine vita agli idonei centri di raccolta differenziata dei rifiuti elettrici ed elettronici, oppure riconsegnarla al rivenditore al momento dell'acquisto di nuova apparecchiatura di tipo equivalente. Lo smaltimento abusivo del prodotto da parte dell'utente comporta l'applicazione delle sanzioni amministrative di cui al Decreto Legislativo N. 49 del 14 Marzo 2014.

#### PL INFORMACJE DLA UŻYTKOWNIKÓW

Pod koniec okresu eksploatacji urządzenie należy oddzielić od pozostałych odpadów. Umieść urządzenie wraz ze wszystkimi jego częściami w centrum przetwarzania odpadów elektronicznych i elektrotechnicznych, wyznaczonego przez lokalne władze.